

CITY OF BATAVIA

CONTROL MONUMENT DIAGRAM

STATION NAME: BATAVIA 103 DATE SET: 6-26-2006 OBSERVATION: 11-7-2017

MONUMENT TYPE: STAINLESS STEEL ROD IN SLEEVE

HORIZONTAL DATUM: NAD 83 (2011), IL EAST ZONE		US FEET	METERS	ACCURACY
LATITUDE: 41°49'52.20083"	NORTHING:	1881067.55	573350.537	NETWORK 0.62 CM
LONGITUDE: 88°19'32.12725"	EASTING:	986360.04	300643.143	

COMBINED SCALE FACTOR: 0.99994679

ORTHOMETRIC HEIGHT	FEET	METERS	DATUM	ACCURACY		
	698.86	213.012	NAVD88	2ND ORDER CLASS I		
ELLIPSOIDAL HEIGHT	FEET	METERS	GEOID HEIGHT	FEET	METERS	SOURCE
	590.31	179.926		-108.56	-33.090	GEOID 12B

STATION DESCRIPTION: ROD WITH DATUM POINT UNDER 6 INCH LID, 18.0 FT SW OF HYDRANT, 19.0 FT N OF NE CORNER OF CONCRETE PAD, 55.0' FT SE OF WATER MANHOLE, 3.0 FT SW OF BACK OF SIDEWALK

FIELD SKETCH:

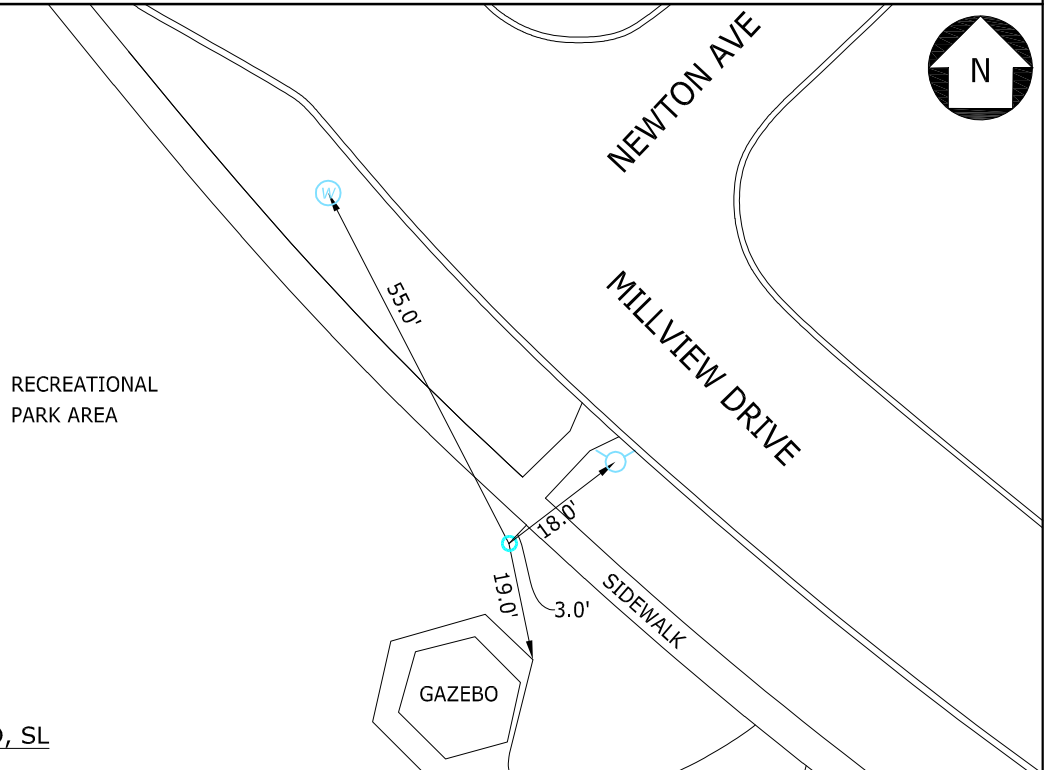

REVIEWED BY: CD, SL

S:\CITY_OF_BATAVIA\21707.088 BENCHMARK UPGRADE\15_SURVEY\15.4_DRAWING_DATA\BATAVIA 103 SET 6-26-2006.DWG

